



MANUAL ROTARY CONTROL CONTINUOUS VARIABLE ATTENUATORS (DC-3GHZ 20DB RANGE)

Product description

- Very small package and broadband performance
- Continuous variable attenuation during operation
- Excellent Repeatability and Long Life Switch
- Low Deviation from Nominal Value
- 50Ω impedance standard, 75Ω available upon request
- 1W CW average power upon request
- Custom Configurations Available Upon Request.



Applications:

Include Communication, 3G, Digital Transmission, Radar, Military, Broadcast & Television, science & Research department etc.

Part Number	Frequency	Power (Watts)	Attenuation Range (dB)
RKT1G3A20	DC-2.5GHz	1	16 typ. 20 max.

Connector: SMA / N type is available, weight: 65g

Temperature (Operational): -10° C~+50° C (Storage) -40° C~+70° C

PN: RKT 1 G 3 A XX

Manual Control Attenuator | Power Handle In Watt | Freq Unit GHz | Freq Number | Product Type | Attenuation Range

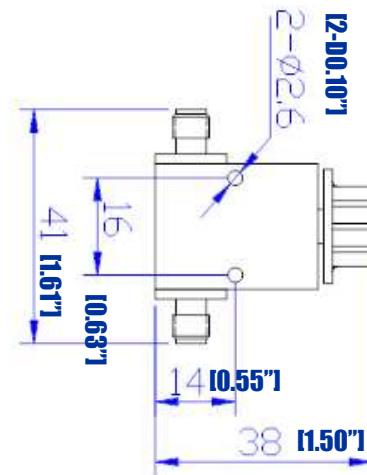
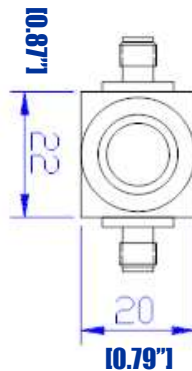
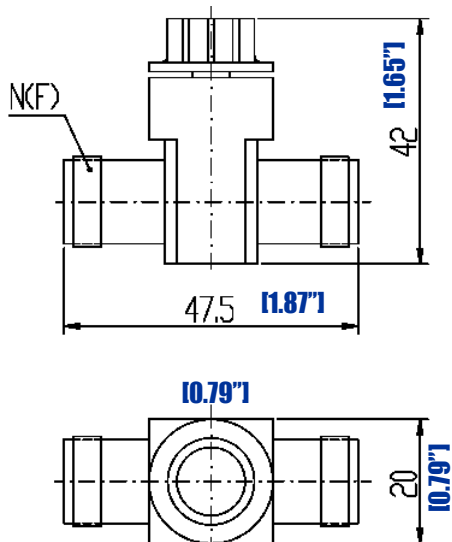

MANUAL CONTROL ROTARY ATTENUATOR (DC-3GH 20DB RANGE)



RF-LAMBDA

The power beyond expectations

RKT1G3A20

PN: RKT 1 G 3 A XX

Manual Power Control Attenuator
 Handle In Watt
 Freq Unit GHz
 Freq Number
 Product Type
 Attenuation Range



MANUAL CONTROL ROTARY ATTENUATOR (DC-3GH 20DB RANGE)

