



Waveguide WR15 Fixed Attenuator 50-75GHz

Features

- WR15 Fixed Waveguide Attenuator
- Low VSWR

Typical Applications

- Microwave Signal Attenuation.
- Test and Measurement.
- Research and Development.
- Radar Applications



Electrical Specifications, 25°C

Part Number	Frequency Range	Attenuation	VSWR	Power Handling
RFWAT15W001-3	50-75GHz	3dB ± 0.5dB	1.6	0.5W
RFWAT15W001-6	50-75GHz	6dB ± 0.5dB	1.6	0.5W
RFWAT15W001-10	50-75GHz	10dB ± 0.5dB	1.6	0.5W
RFWAT15W001-20	50-75GHz	20dB ± 0.5dB	1.6	0.5W
RFWAT15W001-30	50-75GHz	30dB ± 0.5dB	1.6	0.5W

Mechanical Specifications

Waveguide Type	Rectangular Waveguide WR15
Flange Type	UG385/U
Flange Holes	Through
Basis-material	Cuprum
Internal Body Finish	Silver Plated chromate or conversion
External Body Finish	Gray / Blue Paint

Environmental Specifications

Operational Temperature (°C)	-40~ +85
Storage Temperature (°C)	-60 ~ +125
Altitude	45000 ft
Vibration	10g RMS (15 degrees 2KHz)
Humidity	100% RH at 35c, 95%RH at 40 °C
Shock	20G for 11msec

0.5W Waveguide WR15 Fixed Attenuator



Outline Drawing:

All Dimensions in mm [inches]

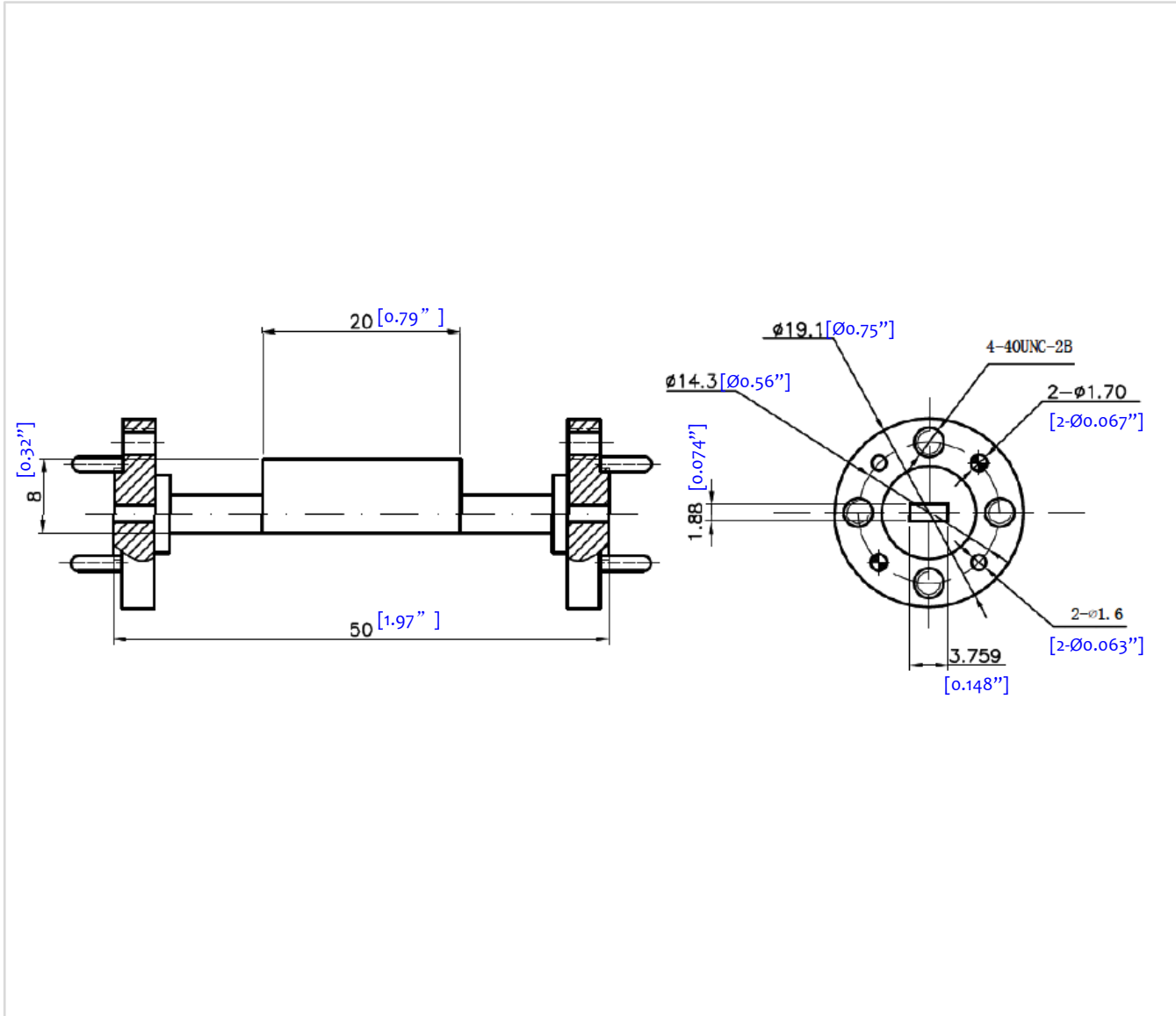

Important Notice

The information contained herein is believed to be reliable. RF-Lambda makes no warranties regarding the information contained herein. RF-Lambda assumes no responsibility or liability whatsoever for any of the information contained herein. RF-Lambda assumes no responsibility or liability whatsoever for the use of the information contained herein. The information contained herein is provided "AS IS, WHERE IS" and with all faults, and the entire risk associated with such information is entirely with the user. All information contained herein is subject to change without notice. Customers should obtain and verify the latest relevant information before placing orders for RF-Lambda products. The information contained herein or any use of such information does not grant, explicitly or implicitly, to any party any patent rights, licenses, or any other intellectual property rights, whether with regard to such information itself or anything described by such information. RF-Lambda products are not warranted or authorized for use as critical components in medical, life-saving, or life sustaining applications, or other applications where a failure would reasonably be expected to cause severe personal injury or death.

0.5W Waveguide WR15 Fixed Attenuator