



RF-LAMBDA

The power beyond expectations

MANUAL CONTROLLABLE STEP ATTENUATOR (DC-4GHz 11DB RANGE)

Product description

Very small package and broadband performance

Adjustable during operation

Excellent Repeatability low deviation

Low Deviation from Nominal Value

50Ω impedance

Higher power is available upon request

Custom Configurations Available Upon Request.

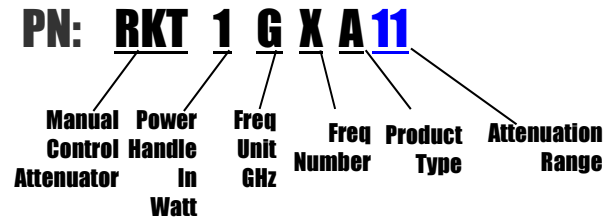

Applications:

Include Communication, 3G, Digital Transmission, Radar, Military, Broadcast & Television, science & Research department etc.

Part Number	Frequency	Power (Watts)	Attenuation Range (dB)	Attenuation Step (dB)	VSWR max.	Insertion Loss (dB)	Accuracy (dB)
RKT1G4A11	DC-4.00	1	11	1	1.50	0.6dB+0.09dB/GHz	± 0.5

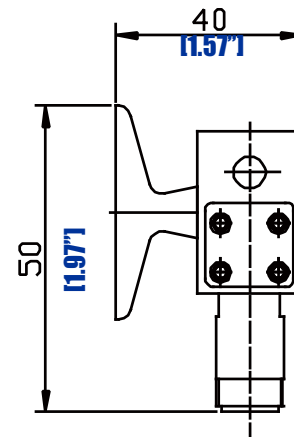
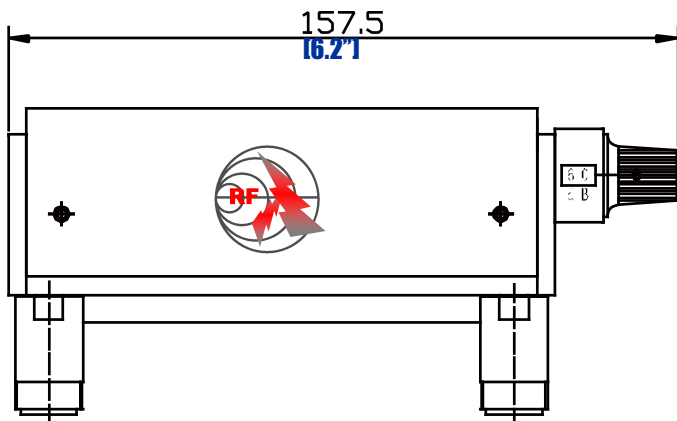

Connector: SMA type, weight: 250g

Temperature (Operational): -10° C~+50° C (Storage) -40° C~+70° C

MANUAL CONTROLLABLE STEP ATTENUATOR

(DC-4GHz 11DB RANGE)